

△ SPECIFICATION MATERIAL
 Insulator: 30%GF THERMOPLASTIC UL94V-0(LCP)
 Contacts: PHOSPHOR BRONZE SQUARE 0.3mm
 CONTACT PLATING
 Underplate: 50u" Nickel
 Contact area: 1u"~30u" Selective Gold
 Solder tails area: 100u" Tin/Lead
ELECTRICAL
 Current rating: 1 Amp
 Contact resistance: 15 milliohm max.
 Insulation resistance: 500 megohm min. at 500v dc
 Dielectric withstanding voltage: 500 VAC / minute
 Operating temperature: -55°C TO +105°C
 Part no.

811 A - XXX X B S A A 3
 1 2 3 4 5 6 7 8 9

- 1.SERIES NO.
811=0.8mm PIN HEADER
- 2.TYPE
A=STANDARD
- 3.CONTACT NUMBER
004 ~ 120
- 4.CONTACT PLATING
G=Gold Flash
S=Selective
A=5u" Gold (selective)
C=15u" Gold (selective)
D=30u" Gold (selective)
- 5.ROW TYPE
B=DUAL LOW
- 6.MOUNTING TYPE
S=STRAIGHT
- 7.PIN LENGTH
A=1.9x5.0mm
- 8.CONTACT INSERTING OPTION
A=FULLY LOADED
- 9.INSULATOR COLOR
3=BLACK

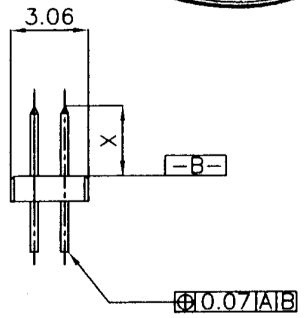
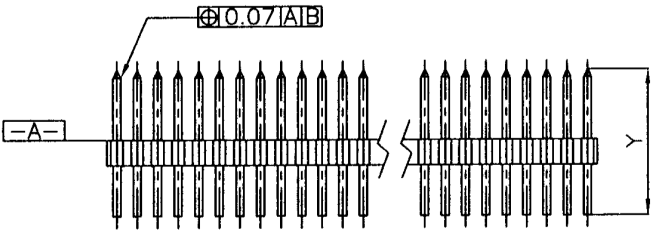

DIM	X	Y
A	1.90	5.00
B		
C		
D		
E		

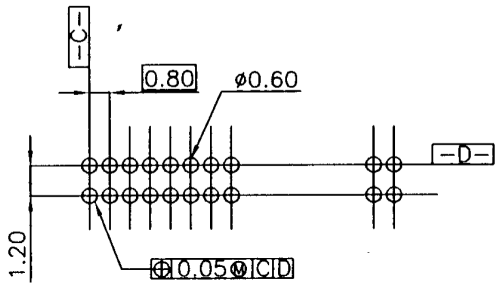

RECOMMENDED P.C.B LAYOUT (TOP VIEW)
 TOLERANCES: ±0.05mm

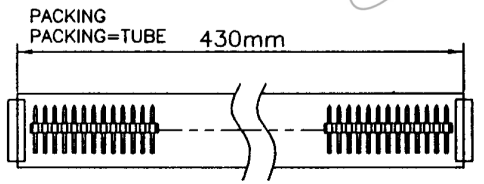

UNLESS OTHERWISE SPECIFIED TOLERANCE		MC-COMPONENTS	
ANG.	±5°		
0.	±0.5	DRAWN NAME: PIN HEADER DIP 0.8X1.2mm	
.0	±0.3		
.00	±0.2		
SCALE: AS SHOWN	UNIT: mm	DRAWN: JOE 03/15/02	
DATE: 03/14/02	CHECKED: <i>MoHo</i> 03/18/02	PRODUCT NO: 811A-XXXXBSAA3	
DATE: 05/17/99	APPROVED: <i>Belce</i> 03/18/02	FILE NAME: 811A-XXXXBSAA3	

REV.	DESCRIPTION	DATE
B	ECN-0203057(May)△	03/14/02
A		05/17/99