

Current Rating: 1 Amp
 Insulation Resistance: 1000 Megohms min
 Contact Resistance: 20 m ohms Max
 Dielectric Withstanding: AC 500 V
 Operating Temperature: -40 ° C to +105° C
 Max Processing Temp: 230 ° C for 30 seconds
 Contact Material: Phosphor Bronze
 Insulator Material: Polyester, UL 94V-0
 ● Standard : NYLON-9T

Part no.

802 D X XXX G B X A A 3
 1 2 3 4 5 6 7 8 9 10

- 1.SERIES NO.
- 2.TYPE.
D=SMT Type
- 3.ENVIRONMENT PROTECTION
MATERIAL:
-General
E=RoHS
- 4.CONTACT NUMBER.
006~120
- 5.CONTACT PLATING.
G=Gold Flash

- 6.ROW TYPE.
B=Dual Row
- 7.PACKING.
0=Tube
1=Tape Reel
- 8.INSULATOR HIGH.
A=2.1mm
- 9.CONTACT INSERTING OPTION.
A=Fully Loaded
- 10.INSULATOR COLOR.
3=Black

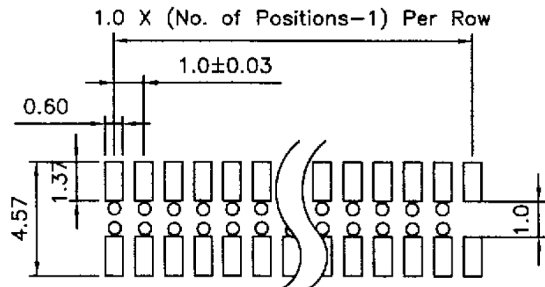
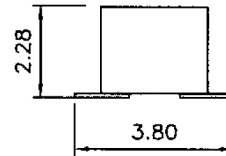
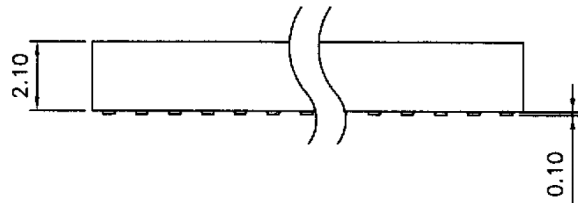
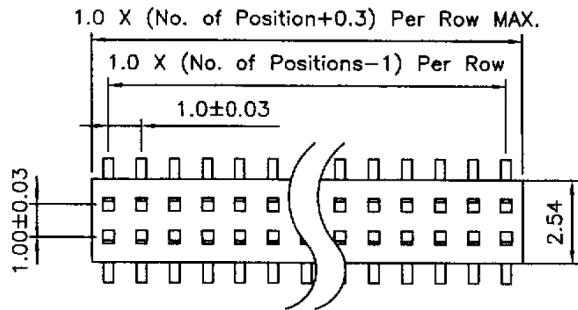
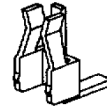

RECOMMENDED P.C.B LAYOUT (TOP VIEW)
TOLERANCES: ±0.05mm

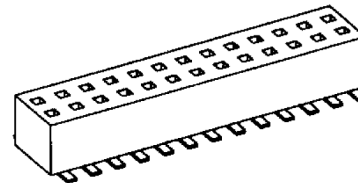

UNLESS OTHERWISE SPECIFIED TOLERANCE	
0.	±0.5
.0	±0.3
.00	±0.2

SCALE: AS SHOWN UNIT: mm

MC-COMPONENTS

C	ECN-0511017(Vicky) Change Outline	11/01/05	DRAWN PEARL	11/02/05	DRAWN NAME:
B	ECN-0110009(angle)A	10/02/01	CHECKED Joe	11/03/05	FEMALE HEADER SMT TYPE PITCH: 1.0mm
A		08/02/00	APPROVED Mike	11/03/05	PRODUCT NO. 802DXXXXGBXAA3
REV.	DESCRIPTION	DATE	SIZE A4	REV. C	FILE NAME: 802DEXXXGBXAA3(W)

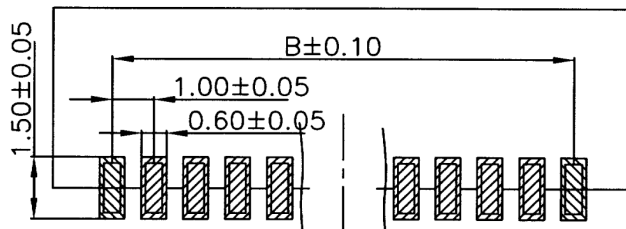
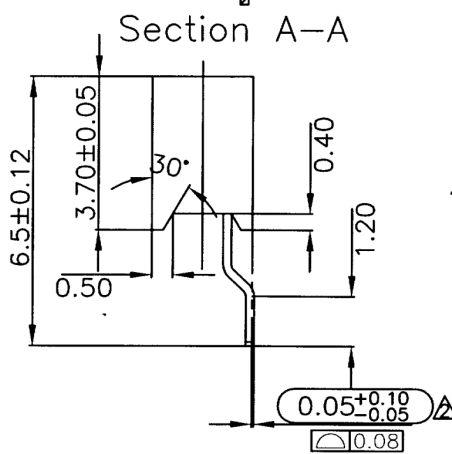
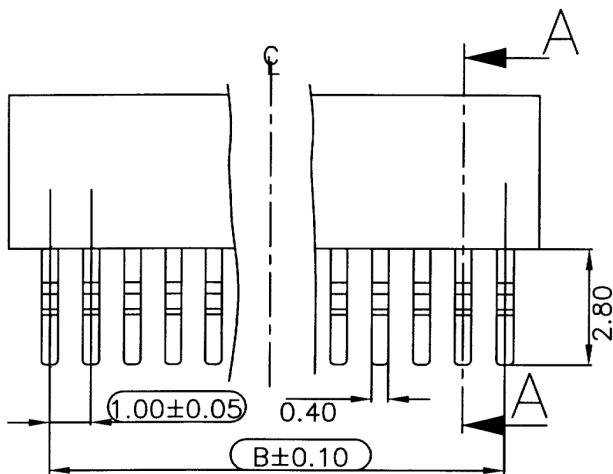
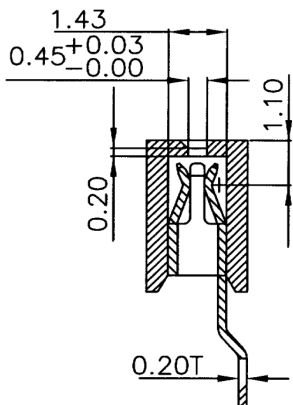
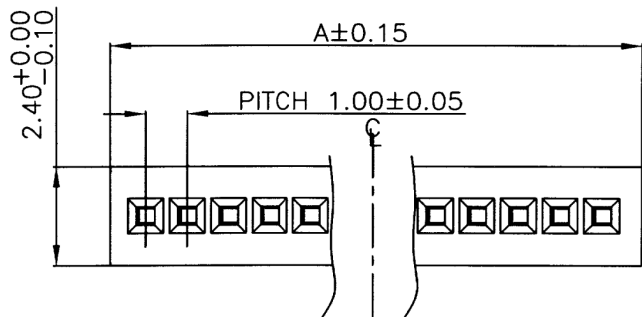

CHANT SINCERE P/NO.	Dim.A	Dim.B
802DE006BA0BA3(NOT RELEASE)	6.80	5.00
802DE010BA0BA3	10.80	9.00
802DE012BA0BA3	12.80	11.00
802DE040BA0BA3(NOT RELEASE)	40.80	39.00

RECOMMENDED P.C.B. LAYOUT
TOLERANCES: ±0.05mm

SPECIFICATION
MATERIAL
 Insulator: Thermal Plastic UL94V-0
 Contacts: Copper Alloy
CONTACT PLATING
 Underplate: 50u"~100u" Nickel
 Contact Area: 1u"~30u" Selective Gold
 Solder Tails Area: 100u"~200u" Tin/Lead(Brighten Tin) or 100u"~200u" Tin/Lead Free(Brighten Tin/Matte Tin)

ELECTRICAL
 Operation Voltage: 250 VAC Max.
 Current Rating: 1 Amp Max.
 Contact Resistance: 15 mohms Max.
 Insulator Resistance: 500 Mohms Min.
 Dielectric Voltage: 500 V AC/ 1 Minute
 Temperature Range: -55°C TO 105°C
MECHANICAL
 INSERTION FORCE: 50 g/ Pin
 PART NO.



802 D X XXX X A 0 B A 3
1 2 3 4 5 6 7 8 9 10

1.SERIES NO.
802=1.0mm FEMALE HEADER

2.TYPE:
D=SMT TYPE

3.ENVIRONMENT PROTECTION MATERIAL.

J=SONY SS-00259(Reserved)
 K=SONY SS-00259(Matte Tin) (Reserved)
 E=RoHS
 F=RoHS (Matte Tin)

4.CONTACT NUMBER:
SEE Contacts

5.CONTACT PLATING:
 G=Gold Flash
 S=Gold Flash (Selective)
 R=3u" Gold (Selective)
 A=5u" Gold (Selective)
 B=10u" Gold (Selective)
 C=15u" Gold (Selective)
 D=30u" Gold (Selective)
 2=20u" Gold (Selective)

6.ROW TYPE:
A=SINGLE LOW
 7.MOUNTING TYPE
FILL IT WITH "0"
 8.PIN LENGTH
B=3.70mm
 9.CONTACT INSULATOR OPTION:
A=FULLY LOADED
 10.INSULATOR COLOR:
3=BLACK

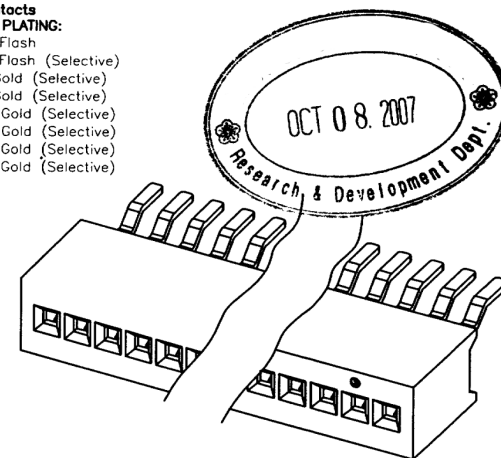

UNLESS OTHERWISE SPECIFIED TOLERANCE	
ANG.	±5°
0.	±0.50
.0	±0.30
.00	±0.20

MC-COMPONENTS

REV.	DESCRIPTION	DATE	REV.	DESCRIPTION	DATE
C	ECN-0702030(Sally) (7,B)(7,C)(7,D)	01/29/07			
B	ECN-0608140(Li) (3,B)	08/17/06			
A	ECN-0606148(Fly)	06/21/06	D	ECN-0710039(Rita) (7,D)	10/05/07

SCALE: AS SHOWN	UNIT: mm
DRAWN RITA	10/05/07
CHECKED <i>Peav</i>	10/05/07
APPROVED <i>Joe</i>	10/08/07
SCALE A4	REV. D

DRAWN NAME:
FEMALE HEADER SMT TYPE CONNECTOR
 PRODUCT NO. 802DEXXXBA0BA3
 FILE NAME: 802DKXXXBA0BA3(GA)

Specifications
 Current Rating: 1.0Amp
 Insulation Resistance: 500M ΩMin.
 Dielectric Withstanding: 200VAC
 Contact Resistance: 20mΩ Max.
 Operating Temperature: -40°C to +105°C
 Max Process Temp: 230°C for 30~60 sec.

Materials
 Contact Material: Phosphor Bronze
 Insulator Material: Polyester, UL 94V-0 LCP
 All materials must be GP materials
 PART NO.

802 D E XXX X B X A A 3
 1 2 3 4 5 6 7 8 9 10

- 1. SERIES NO.
- 2. TYPE.
D=SMT Type
- 3. GREEN OPTION:
E=RoHS
- 4. CONTACT NUMBER.
003~040
- 5. CONTACT PLATING.
T= Tin Plated
G= Gold Flash
- 6. ROW TYPE.
B= Dual Row
- 7. PEG/CAP OPTION:
△1=W/O Peg+Tube
2=W/Peg+Tube
3=W/O Peg+W/Pad+Tube
4=W/Peg+W/Pad+Tube
A=W/Peg+W/O Pad+Tape Reel
B=W/Peg+W/Pad+Tape Reel
- 8. INSULATOR HIGH.
A=2.1mm
- 9. CONTACT INSERTING OPTION.
A=Fully Loaded
- 10. INSULATOR COLOR.
3=Black

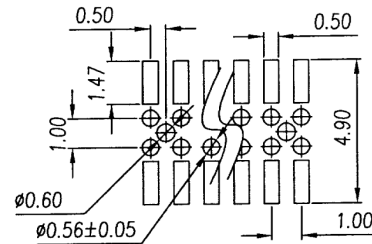
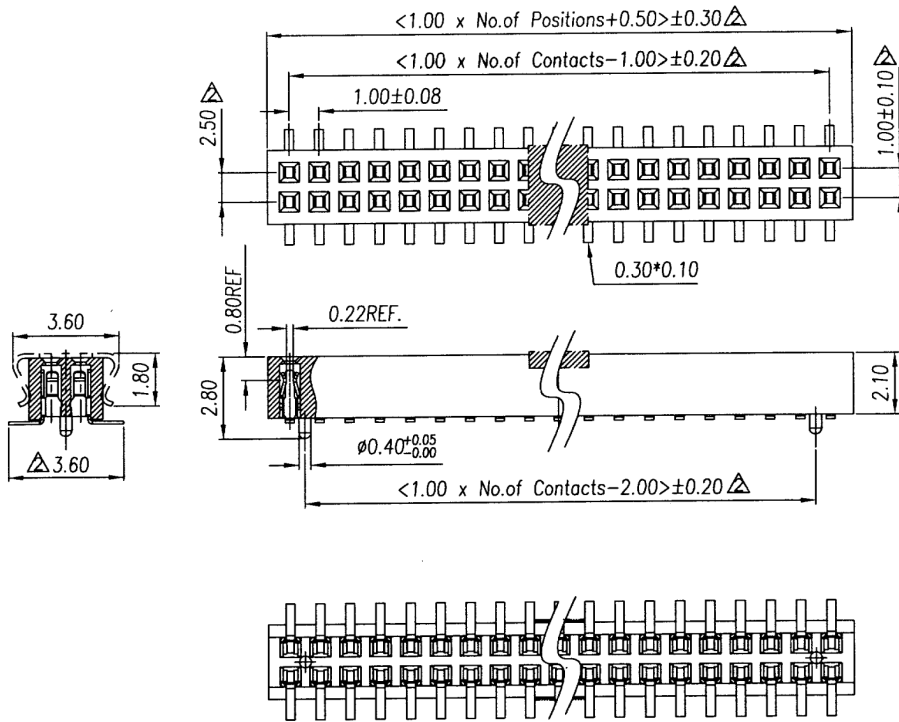

RECOMMENDED P.C.B LAYOUT
 FOR BOTTOM ENTRY
 TOLERANCES: ±0.05mm



UNLESS OTHERWISE SPECIFIED TOLERANCE		SCALE: AS SHOWN		UNIT: mm		MC-COMPONENTS
ANG.	±5°					
0.	±0.30					DRAWN NAME: FEMALE HEADER SMT TYPE PITCH: 1.0mm
.0	±0.20					
.00	±0.15					PRODUCT NO. 802DEXXXXBXAA3
.000	±0.10					
REV.	DESCRIPTION	DATE	SIZE	REV.	FILE NAME:	802DEXXXXBXAA3(Q3)

C	ECN-0810120(Sylvia) △ (1,D)(2,F)(4,D)(4,F)	10/17/08	DRAWN	JOE	10/17/08
B	ECN-0611003(Doris) △ (9,E)	10/25/06	CHECKED	peav	10/17/08
A	DRA-0609028(Doris)	09/18/06	APPROVED	Joe	10/17/08

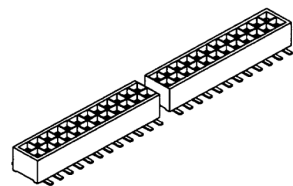
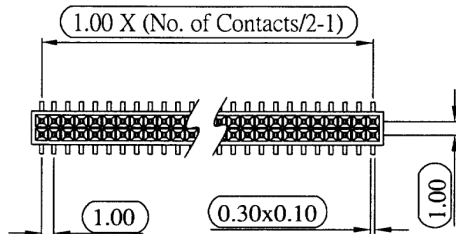

Current Rating: 1 Amps
 Insulator Resistance: 1000 Megohms min
 Contact Resistance: 20 m ohms max
 Dielectric Withstanding: AC 300 V
 Operating Temperature: -40~+105°C
 Max Processing Temp: 230°C for 60 seconds
 260°C for 10 seconds
 Contact Material: Phosphor Bronze
 Insulator Material: Polyester,UL 94V-0
 Standard:L.C.P

Finish: Tin,Gold Plated
 Standard:Gold Flash all over nickel

PART NO.

802 D X XXX X B 5 C A 3
 1 2 3 4 5 6 7 8 9 10

- 1.SERIES NO.
802=1.0mm Female Header
- 2.TYPE:
D=SMT TYPE
- 3.GREEN OPTION:
E=RoHS(Bright)
F=RoHS(Matte)
- 4.CONTACT NUMBER:
02~50
- 5.CONTACT PLATING:
G=Gold Flash
S=Gold Flash (Selective)
R=3u" Gold (Selective)
A=5u" Gold (Selective)
B=10u" Gold (Selective)
C=15u" Gold (Selective)
D=30u" Gold (Selective)
- 6.ROW TYPE:
B=Dual Row
- 7.PACKING OPTION"
5=W/Peg+Tube
- 8.PIN LENGTH
C=3.90mm
- 9.CONTACT INSULATOR OPTION:
A=Fully Loaded
- 10.INSULATOR COLOR:
3=Black

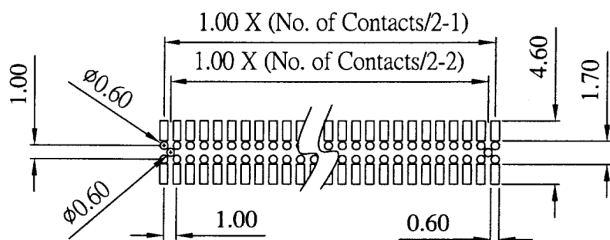
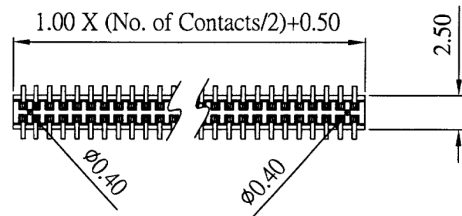
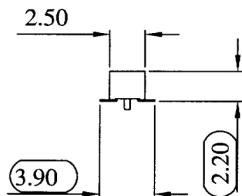
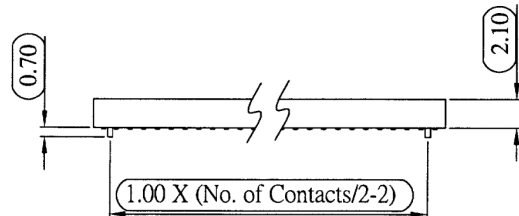

Recommended P.C. Board
 SMD Layout
 Tolerances: ±0.05mm



UNLESS OTHERWISE SPECIFIED TOLERANCE		MC-COMPONENTS
± 0.20		
SCALE: AS SHOWN	UNIT: mm	DRAWN NAME: FEMALE HEADER SMT TYPE CONNECTOR 1.0mm*1.0mm PRODUCT NO. 802DXXXXXB5CA3 FILE NAME: 802DFXXXXB5CA3(C6)
DRAWN	JOE 03/04/09	
CHECKED	Joe 03/04/09	
APPROVED	Joe 03/04/09	

REV.	DESCRIPTION	DATE
A	ECN-0903027(Sally)	03/04/09

1 2 3 4 5 6 7 8 9 10