

UNLESS OTHERWISE SPECIFIED TOLERANCE	
ANG.	±5°
0.	±0.5
.0	±0.3
.00	±0.2
SCALE: AS SHOWN	UNIT: mm

MC-COMPONENTS

REV.	DESCRIPTION	DATE	SIZE	REV.	FILE NAME:
B	ECN-0509175(Lily) (5,E)(7,E)	09/26/05	A4	B	801DXXXXXB0X3
A	DRA-0310021(Joyce)	10/16/03			801DEXXXB10X3(W)

DRAWN	JOE	09/28/05
CHECKED	pearl	09/28/05
APPROVED	M. Joy	10/16/05

DRAWN NAME:	PIN HEADER SMT 1.0mm
PRODUCT NO.	801DXXXXXB0X3
FILE NAME:	801DEXXXB10X3(W)



SPECIFICATION
MATERIAL
 Δ Insulator: Thermal Plastic UL94V-0
 Contacts: Copper Alloy
CONTACT PLATING
 Underplate: 50u" Nickel
 Contact Area: 1u"~30u" Selective Gold
 Solder Tails Area: 100u" Tin/Lead(Brighten Tin)or
 100u" Tin/Lead Free(Brighten Tin/Matte Tin)

Part no. **801 D X XXX X B Q X A 3**
 1 2 3 4 5 6 7 8 9 10

- 1. SERIES NO.
- 2. TYPE: A=Standard
- 3. ENVIRONMENT PROTECTION MATERIAL:
 - General
 - J=SONY SS-00259(Reserved)
 - K=SONY SS-00259(Matte Tin) (Reserved)
 - E=RoHS
 - F=RoHS(Matte Tin)
- 4. CONTACT NUMBER: 004 ~ 080
- 5. CONTACT AREA PLATING:
 - G=Gold Flash
 - S=Gold Flash (Selective)
 - A=5u" Gold (Selective)
 - B=10u" Gold (Selective)
 - C=15u" Gold (Selective)
 - D=30u" Gold (Selective)
- 6. POW TYPE
 - B=Dual Low
- 7. FILL IT WITH " 0 "
- 8. PIN LENGTH
 - Δ 0=1.9x5.21mm
 - A=2.8x4.32mm
 - Δ B=2.4x4.32mm
- 9. CONTACT INSERTING OPTION
 - A=FULLY LOADED
- 10. INSULATOR COLOR:
 - 3=Black

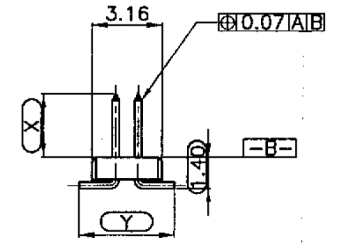
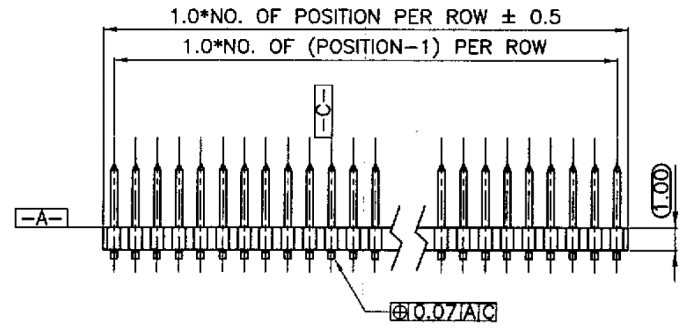
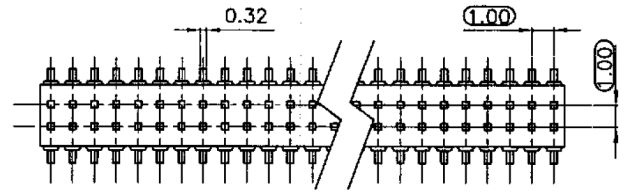

MOUNTING TYPE	DIM			
	X	Y	E Δ	F Δ
Δ 0	1.9	5.21	6.20	2.50
A	2.80	4.32	5.30	2.00
Δ B	2.40	4.32	5.30	2.00

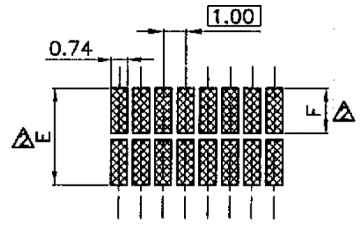

RECOMMENDED P.C.B LAYOUT (TOP VIEW)
 TOLERANCES: ±0.05mm

PACKING
 PACKING=TUBE

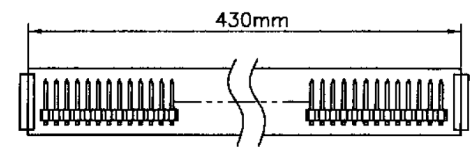

UNLESS OTHERWISE SPECIFIED TOLERANCE	
ANG.	±5°
0.	±0.5
.0	±0.3
.00	±0.2
SCALE: AS SHOWN	UNIT: mm
DRAWN PEARL	04/12/06
CHECKED Joe	04/13/06
APPROVED Mark	06/13/06
SIZE A4	REV. D

MC-COMPONENTS

DRAWN NAME:
 PIN HEADER SMT 1.0mm
 PRODUCT NO. 801DXXXXXBOXA3
 FILE NAME: 801DKXXXXXBOXA3

REV.	DESCRIPTION	DATE	REV.	DESCRIPTION	DATE
C	ECN-0112121(Joyce) Δ	12/28/01			
B	ECN-0105018(lucy) Δ	05/03/01			
A		05/12/99	D	ECN-0604071(Christy) Δ (7,G)(7,F)	04/10/06

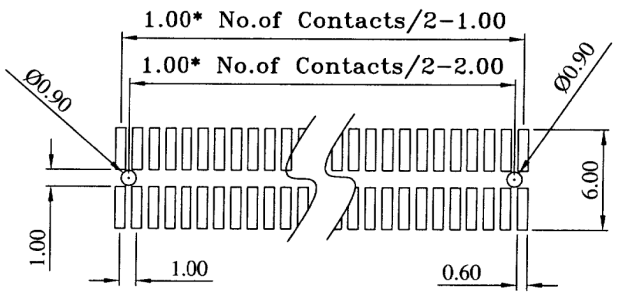
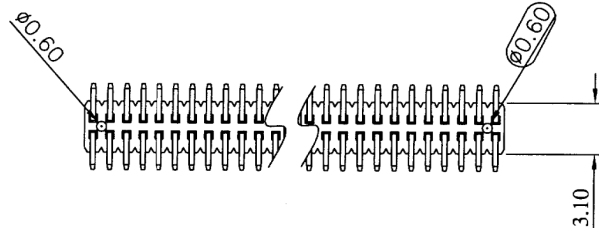
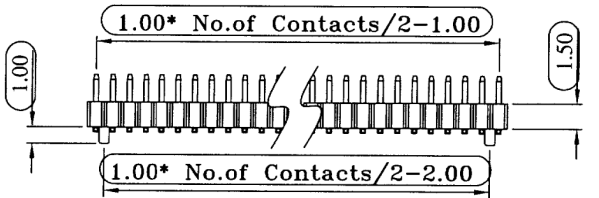
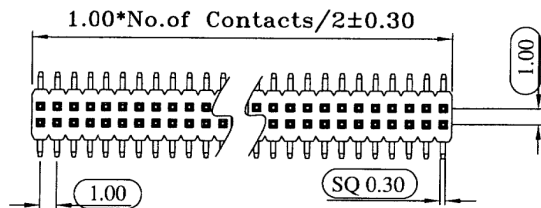

Recommended P.C. Board
SMD Layout
Tolerances: ±0.05mm

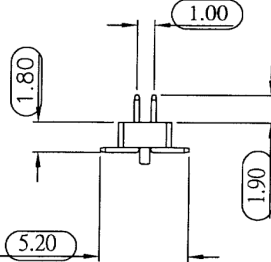
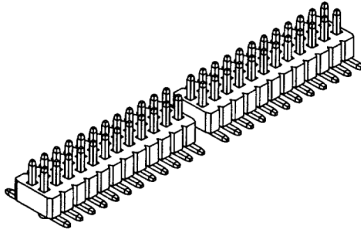

Current Rating: 1 Amps
Insulator Resistance: 1000 Megohms min
Dielectric Withstanding: 300 V AC
Contact Resistance: 20m Min.
Operating Temperature: -40~+85°C
Max Processing Temp: 230°C for 60 seconds
Max Processing Temp: 260°C for 10 seconds
Contact Material: Copper Alloy
Insulator Material: Polyester, UL 94V-0
Standard: LCP

- PART NO. 801 D X XXX X B 2 0 C 3
1 2 3 4 5 6 7 8 9 10
- 1.SERIES NO.
801=1.0mm PIN HEADER
 - 2.TYPE
D=S.M.T.
 - 3.GREEN OPTION:
E=RoHS(Bright)
F=RoHS(Matte)
 - 3.CONTACT NUMBER
004 ~ 080
 - 4.CONTACT PLATING
S=selective gold
G=gold flash
A=5u" gold (selective)
C=15u" gold (selective)
D=30u" gold (selective)
V=10u" gold flash
 - 6.ROW TYPE
B=Dual Row
 - 7.PEG OPTION
2=W/Peg
 - 8.PIN LENGTH
0=1.90*5.20mm
 - 9.CONTACT INSERTING OPTION
C=Fullay Loaded+Tube
 - 10.INSULATOR COLOR
3=Black



UNLESS OTHERWISE SPECIFIED TOLERANCE		MC-COMPONENTS
±0.20		
SCALE: AS SHOWN	UNIT: mm	
DRAWN JOE	03/05/09	DRAWN NAME:
CHECKED Pearl	03/05/09	PIN HEADER SMT 1.0mm
APPROVED Joe	03/05/09	PRODUCT NO. 801DXXXXXB20C
		FILE NAME: 801DFXXXXB20C3(C6)

REV.	DESCRIPTION	DATE
A	ECN-0903028(Sally)	03/04/09

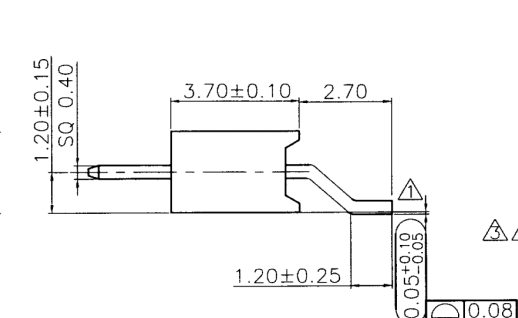
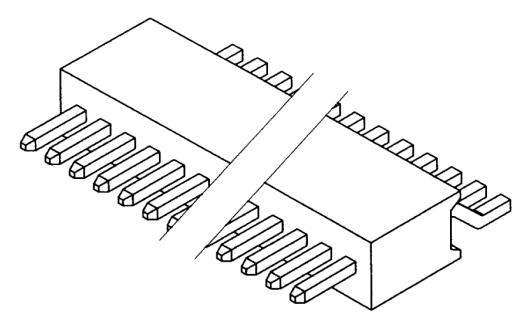
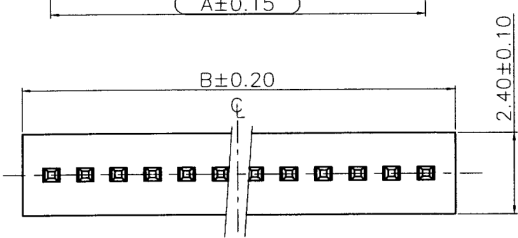
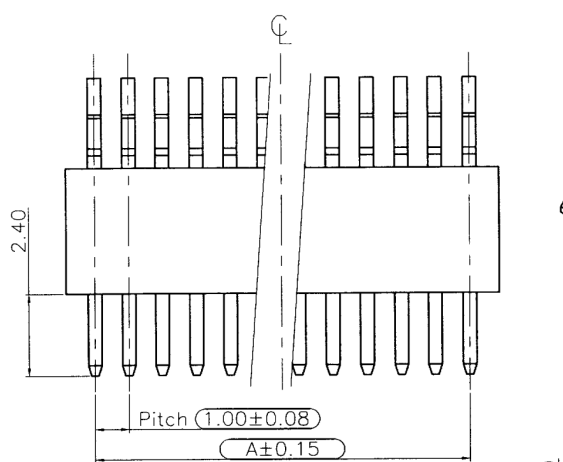

Recommended P.C.B Layout
TOLERANCES: ±0.05mm
(Component Side)

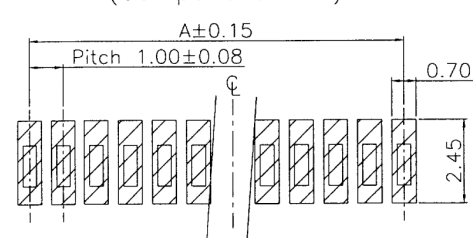

Dimensional Information

CHANT SINCERE P/NO.	Dim.A	Dim.B
801DE010BA0BA3	9.00	10.70
801DE012BA0BA3	11.00	12.70
801DE020BA0BA3 (NOT RELEASE)	19.00	20.70
801DE030BA0BA3 (NOT RELEASE)	29.00	30.70
801DE040BA0BA3 (NOT RELEASE)	39.00	40.70
801DE050BA0BA3 (NOT RELEASE)	49.00	50.70

SPECIFICATION
MATERIAL
 Insulator: Thermal Plastic UL94V-0
 Contacts: Copper Alloy
CONTACT PLATING
 Underplate: 50u"~100u" Nickel
 Contact Area: 1u"~20u" Selective Gold
 Solder Tails Area: 100u"~200u" Tin/Lead(Brighten Tin)or
 100u"~200u" Tin/Lead Free(Brighten Tin/Matte Tin)
ELECTRICAL
 Operation Voltage: 250 VAC Max.
 Current Rating: 1 Amp Max.
 Contact Resistance: 15 mohms Max.
 Insulator Resistance: 500 Mohms Min.
 Dielectric Voltage: 500 V AC/ 1 Minute
 Temperature Range: -55°C to 105°C
MECHANICAL
 INSERTION FORCE:50g/Pin
 Part no.

801 D X XXX B A 0 B A 3
 1 2 3 4 5 6 7 8 9 10

- 1.SERIES NO.
- 2.TYPE:
D=SMT TYPE
- 3.ENVIRONMENT PROTECTION MATERIAL.
J=SONY SS-00259(Reserved)
K=SONY SS-00259(Matte Tin) (Reserved)
E=RoHS
F=RoHS (Matte Tin)
- 4.CONTACT NUMBER:
SEE Contacts
- 5.CONTACT PLATING:
G=Gold Flash
S=1u" Gold (Selective)
B=10u" Gold (Selective)
2=20u" Gold (Selective)
- 6.ROW TYPE:
A=SINGLE LOW
- 7.MOUNTING TYPE
FILL IT WITH "0"
- 8.PIN LENGTH
B=2.40mm
- 9.CONTACT INSULATOR OPTION:
A=FULLY LOADED
- 10.INSULATOR COLOR:
3=BLACK



UNLESS OTHERWISE SPECIFIED TOLERANCE	
ANG.	±5°
0.	±0.50
.0	±0.30
.00	±0.20

MC-COMPONENTS

SCALE: AS SHOWN UNIT: mm

DRAWN NAME: Rita
pin Header SMT TYPE
1.00 Pitch BtoB full

CHECKED: Pearl
10/08/07

APPROVED: Joe
10/08/07

PRODUCT NO. 801DXXXXBA0BA3

FILE NAME: 801DKXXXXBA0BA3(GA)

REV.	DESCRIPTION	DATE	REV.	DESCRIPTION	DATE
C	ECN-0702019(Sally) (7,D)	01/29/07			
B	ECN-0608139(Li) (6,D)	08/17/06			
A	ECN-0604041(Li)	03/09/06	D	ECN-0710038(Rita) (7,C)(7,G)	10/05/07