

A 1 2 3 4 5 6 7 8

# [1812022S] SERIES

Wafer Connector, Pitch 1.25mm  
SMT, Straight, Type 2

Physical:

**Housing:** NY, UL 94V-0  
**Contact:** Copper Alloy  
**Specifications:**

**Voltage Current Rating:** 3A max  
**Insulation Resistance:** 1000M ohm min  
**Contact Resistance:** 20m ohm max  
**Dielectric Withstanding Voltage:** 800VAC  
**Temperature Rating:** -25°C To +85°C  
**IR Reflow Soldering Temperature:**  
**Lead Part:** 220°C, 5sec  
**RoHS Part:** 260°C, 5sec

**ORDERING CODE:**

**1812022 S 10 00 -8 R LF**  
1 2 3 4 5 6 7

- 1. SERIES NO.
- 2. NO. OF STYLE
- S=STRAIGHT/VERTICAL
- 3. NO. OF PINS
- 4. PLATED
- 00=TIN PLATED
- 5. ECN CODE
- 6. PACKAGE
- R=REEL
- 7. PRODUCT'S STATUS
- NON-SHOWED=STANDARD TYPE
- LF=RoHS COMPLIANT

# MC-COMPONENTS

CUSTOMER COPY



TITLE	WAFER CONNECTOR
DWG NO.	1812022SXXXX-8R
SCALE	1:1 SHEET 1 OF 1

UNIT:mm  
SIZE: A4



REV.	DATE	APPD.	CHR.	DR.	TOLERANCE UNLESS OTHERWISE SPECIFIED
1.0	2004/04/30	DENNIS	DAVID	MAY	LINEAR 0.0±0.25
1.2	2005/04/14	DENNIS	BING	JANE	0.00±0.15
1.3	2006/11/21	DENNIS	DDP	LILY	ANGLES ±3

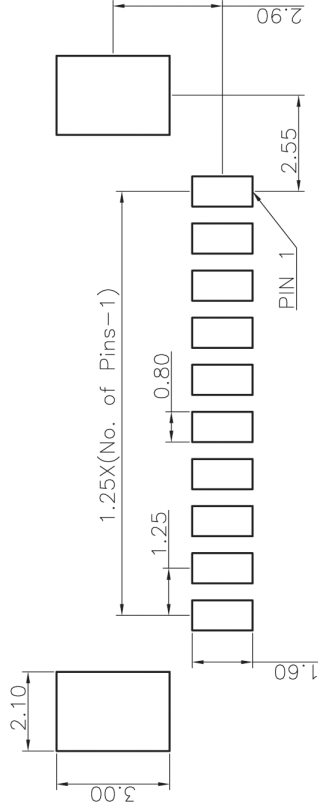
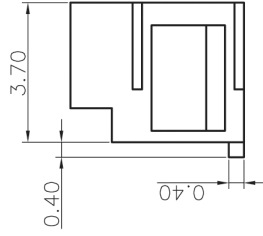
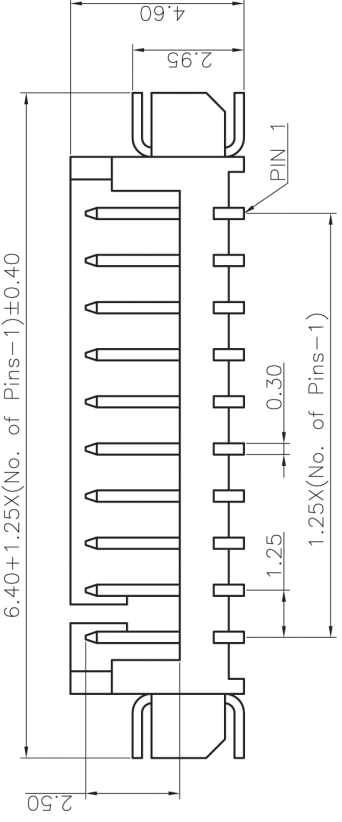
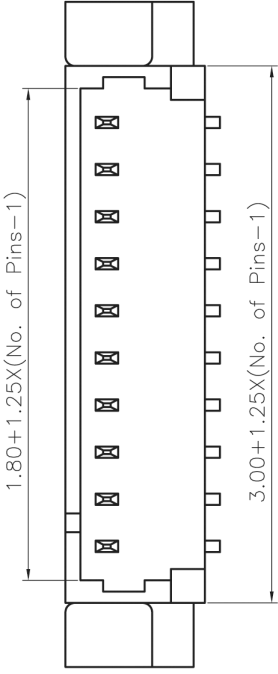

TOP VIEW  
PCB LAYOUT RECOMMENDED

A 1 2 3 4 5 6 7 8