

RECOMMENDED P.C.B LAYOUT (COMPONENT SIDE)
GENERAL TOLERANCE : ±0.05mm

SPECIFICATION

MATERIAL
Insulator: Thermoplastic, rated UL94V-0
Contacts: Copper Alloy
Shell: Steel
CONTACT PLATING
Underplate: 50u"~100u" Nickel
Contact area: 3u" Selective gold
Solder tails area: 100u"~200u" Tin (Lead Free)
ELECTRICAL
Operation voltage: 250 V
Current rating: 2.5 Amps max.
Contact resistance: 25 mohms initial
Insulation resistance: 3000 Mohms min @ 500 VDC
Dielectric withstanding voltage: 500 VAC / minute
Temperature range: -55°C TO +85°C

Part no.

102 F G 15 F R T 01 N 1 A X
1 2 3 4 5 6 7 8 9 10 11 12

- | | |
|--|--|
| 1.SERIES NO.
102=D-SUB | 6.CONTACT AREA PLATING:
R=3u" GOLD |
| 2.F=SMT Type | 7.SOLDER TAILS AREA PLATING:
T=100u"~200u" TIN(Lead Free) |
| 3.GREEN OPTION:
--General
E=RoHS (Bright)
G=RoHS (Bright)(Halogen free) | 8.APPLY TYPE:
01=L-Shape Type |
| 4.CONTACT NUMBER:
15=15 PINS | 9.SHELL PLATING:
N=Plating Nickel |
| 5.CONTACT TYPE:
F=FEMALE | 10.1=With Shielding |
| | 11.PACKING STYLE:
A=TRAY |
| | 12.INSULATOR COLOR:
2=Blue
3=Black |

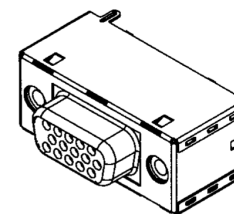
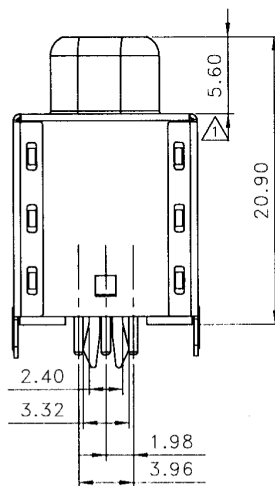
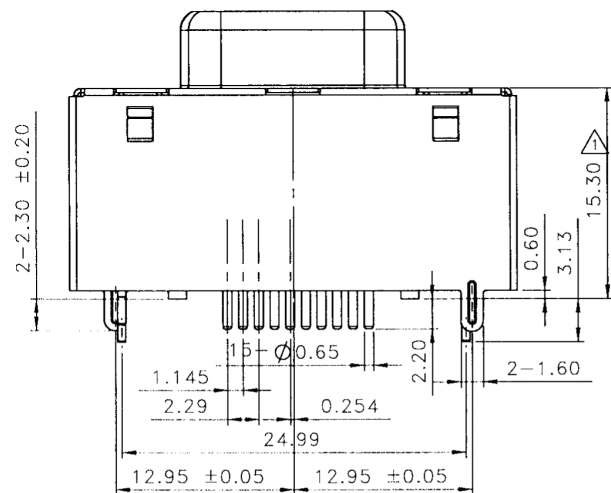

UNLESS OTHERWISE SPECIFIED TOLERANCE	
ANG.	+5°
0.	+0.50
.0	+0.30
.00	+0.20

MC-COMPONENTS

SCALE: AS SHOWN UNIT: mm

A	X2	△ REVISD DIMENSION (2.G)(4.D)(4.F)(6.D)	/ /	DRAWN JASON	11/13/09	DRAWN NAME: D-SUB 15P Female Straight H/D With Shielding
	X1		11/13/09	CHECKED		
	REV.	DESCRIPTION	DATE	APPROVED	10/30/09	PRODUCT NO. 102FG15FRT01N1AX
				SIZE A4	REV. X2	FILE NAME: C-102FG15FRT01N1AX

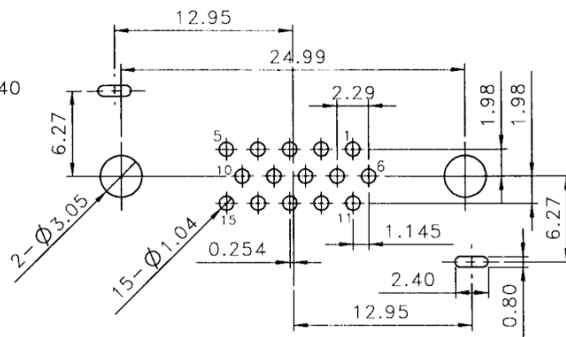
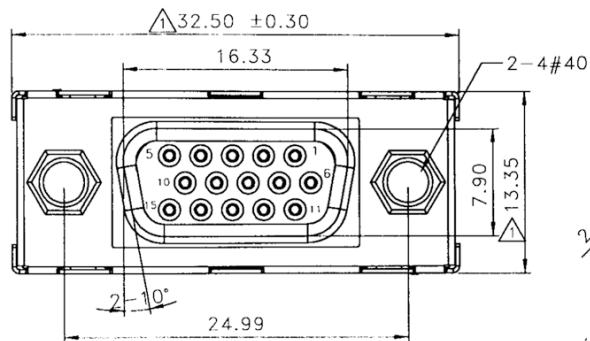

RECOMMENDED P.C.B LAYOUT (COMPONENT SIDE)
GENERAL TOLERANCE: ±0.05mm

SPECIFICATION

MATERIAL
 Insulator: Thermoplastic, rated UL94V-0
 Contacts: Copper Alloy
 Shell: Steel
CONTACT PLATING
 Underplate: 50u"~100u" Nickel
 Contact area: 3u" Selective gold
 Solder tails area: 100u"~200u" Tin (Lead Free)
ELECTRICAL
 Operation voltage: 250 V
 Current rating: 2.5 Amps max.
 Contact resistance: 25 mohms initial
 Insulation resistance: 3000 Mohms min @ 500 VDC
 Dielectric withstanding voltage: 500 VAC / minute
 Temperature range: -55°C TO +85°C

Part no.

102 F E 15 F R T 01 N 3 A X
 1 2 3 4 5 6 7 8 9 10 11 12

- 1.SERIES NO.
102=D-SUB
- 2.F=SMT Type
- 3.GREEN OPTION:
-=General
E=RoHS (Bright)
G=RoHS (Bright)(Halogen free)
- 4.CONTACT NUMBER:
15=15 PINS
- 5.CONTACT TYPE:
F=FEMALE
- 6.CONTACT AREA PLATING:
R=3u" GOLD
- 7.SOLDER TAILS AREA PLATING:
T=100u"~200u" TIN(Lead Free)
- 8.APPLY TYPE:
01=L-Shape Type
- 9.SHELL PLATING:
N=Plating Nickel
- 10.3=With Shielding and Screw
- 11.PACKING STYLE:
A=TRAY
- 12.INSULATOR COLOR:
2=Blue
3=Black

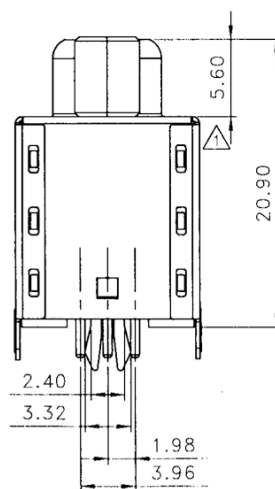
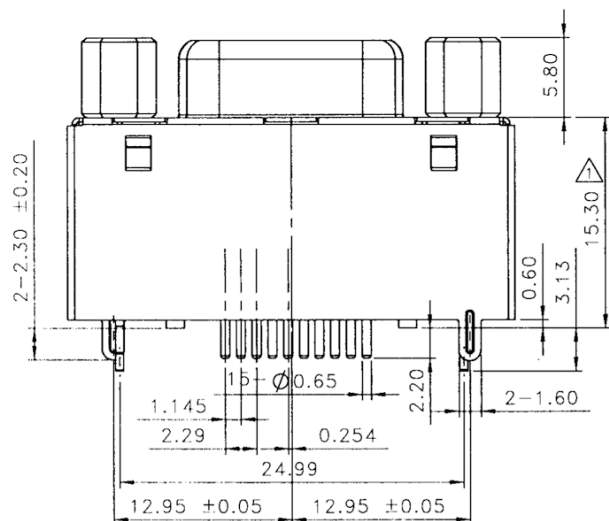
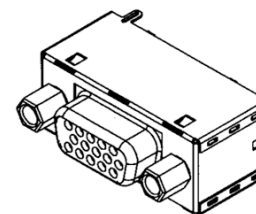

UNLESS OTHERWISE SPECIFIED TOLERANCE	
ANG.	±5°
0.	±0.50
.0	±0.30
.00	±0.20

MC-COMPONENTS

SCALE: AS SHOWN UNIT: mm

DRAWN JASON 11/13/09

CHECKED

APPROVE *Walter* 11/16/09

DATE

SIZE A4 REV. X2

DRAWN NAME:
D-SUB 15P Female Straight H/D
With Shielding and Screw

PRODUCT NO. 102FE15FR101N3AX

FILE NAME: C:\102FE15FR101N3AX

X2	△ REVISD DIMENSION (2.G)(4.D)(4.F)(6.D)	/ /	11/13/09
X1			10/30/09
REV.	DESCRIPTION	DATE	