

△ 杯口朝大邊(M,C) △ 杯口朝小邊(N,Q)

POSITION	A	B	C	D	E	F
15(M,C,N,Q)	16.92	25.00	30.8	2.29	1.14	19.2
26(M,C,N,Q)	25.25	33.30	39.2	2.29	1.14	27.7
44(M,C,N,Q)	38.96	47.10	53.1	2.29	1.14	41.1
62(M,C,N,Q)	55.42	63.50	69.4	2.41	1.20	57.3

**SPECIFICATION**  
**MATERIAL**  
 Insulator: Thermal Plastic UL94V-0  
 Contacts: Copper Alloy  
 Shell: Steel  
 Rivet,Boardlock: Copper Alloy  
**CONTACT PLATING**  
 Underplate: 50u"~100u" Nickel  
 Contact Area: 1u"~30u" Selective Gold  
 Solder Tails Area: 100u"~200u" Tin/Lead(Brighten Tin)or 100u"~200u" Tin/Lead Free(Brighten Tin/Matte Tin)  
**ELECTRICAL**  
 Operation Voltage: 250 VAC Max.  
 Current Rating: 3 Amps Max.  
 Contact Resistance: 15 mohms Max. @ 500 VDC  
 Dielectric Withstanding Voltage: 1000 VAC / Minute  
 Operating Temperature: -55°C To +105°C  
**PART NO.**

101 A X XX X X X A A A X  
 1 2 3 4 5 6 7 8 9 10 11

- 1.SERIES NO.
- 2.TYPE: A=Standard
- 3.ENVIRONMENT PROTECTION MATERIAL:  
 --General  
 J=SONY SS-00259(Reserved)  
 K=SONY SS-00259(Matte Tin) (Reserved)  
 E=RoHS  
 F=RoHS(Matte Tin)
- 4.CONTACT NUMBER  
 15 26 44 62
- 5.CONTACT TYPE:  
 M=Male(杯口朝大邊)  
 C=Male (一般塑膠)(杯口朝大邊)  
 N=Male(杯口朝小邊)  
 Q=Male (一般塑膠)(杯口朝小邊)
- 6.CONTACT AREA PLATING:  
 G=Gold Flash  
 S=1u" Gold (Selective)  
 A=5u" Gold (Selective)  
 B=10u" Gold (Selective)  
 C=15u" Gold (Selective)  
 D=30u" Gold (Selective)  
 H=1u" Gold Flash 30u" on Contact Area  
 M=2u" Gold Plated
- 7.SHELL PLATING:  
 △ P=Tin Plated+Dimple  
 △ Q=Nickel Plated+Dimple  
 △ Z=Zinc Plated
- 8.PROCESS OPTION:  
 A=Thru. Hole
- 9.PARTS OPTION:  
 A=Non-Accessories
- 10.CONTACT INSERTING OPTIN:  
 A=Fully Loaded
- 11.INSULATOR COLOR:  
 1=White  
 2=Blue  
 3=Black  
 4=Gray



UNLESS OTHERWISE SPECIFIED TOLERANCE		<b>MC-COMPONENTS</b>
ANG.	±5"	
0.	±0.5	
.0	±0.3	
.00	±0.2	
SCALE: AS SHOWN	UNIT: mm	
DRAWN JOE	05/24/07	DRAWN NAME:
CHECKED Pearl	05/28/07	HIGH DENSITY D-SUB SOLDER
APPROVED Blank at 5/28/07		PRODUCT NO. 101AXXXXXXAAAX
SIZE A4	REV. G	FILE NAME: 101AKXXMXXAAAX

D	ECN-0408056(Angela)△	08/13/04	G	ECN-0705179(Tiffany)△ (2,F)	05/24/07
C	ECN-0106085(joe)△	06/21/01	F	ECN-0602008(Liyy)△ (8,B)	01/26/06
B	ECN-0101124	01/30/01	E	ECN-0509085(Kelly)△ (7,F)(7,E)	09/13/05
REV.	DESCRIPTION	DATE	REV.	DESCRIPTION	DATE

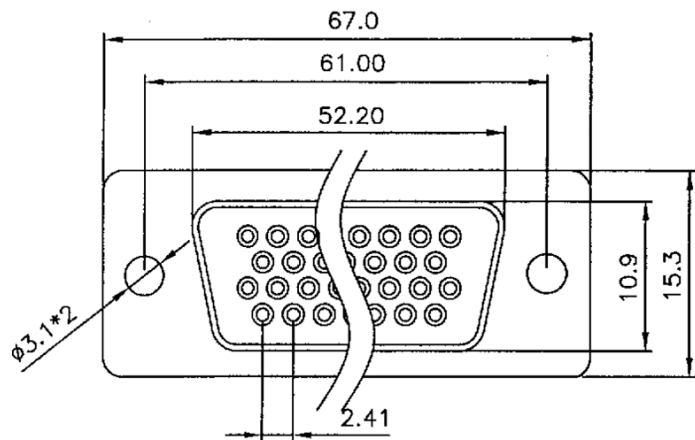

RoHS  
compliant

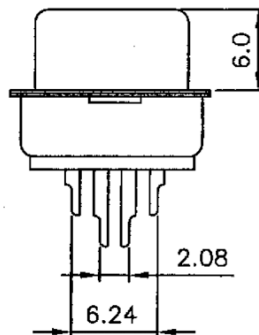
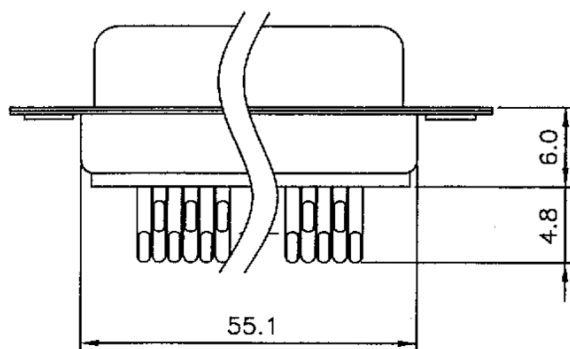

**SPECIFICATION**

**MATERIAL**

- △ Insulator: Thermal Plastic UL94V-0
- Contacts: Copper Alloy
- Shell: Stainless Steel
- Rivet, Boardlock: Copper Alloy

**CONTACT PLATING**

- Underplate: 50µ" Nickel
- Contact Area: 1µ"~30µ" Selective Gold
- △ Solder Tails Area: 100µ" Tin/Lead (Brighten Tin) or 100µ" Tin/Lead Free (Brighten Tin/Matten Tin)

**ELECTRICAL**

- Operation Voltage: 250 VAC Max.
- Current Rating: 3 Amps Max.
- Contact Resistance: 15 mohms Max. △
- Dielectric Withstanding Voltage: 1000 VAC / minute
- Operating Temperature: -55°C to +105°C

PART NO. 101 A X 78 X X X A A A X  
1 2 3 4 5 6 7 8 9 10 11

- 1. SERIES NO.
- 2. TYPE: A=standard
- △ 3. ENVIRONMENT PROTECTION MATERIAL:
  - =General
  - J=SONY SS-00259(Reserved)
  - K=SONY SS-00259(Matte Tin)
  - (Reserved)
  - E=RoHS
  - F=RoHS (Matte Tin)
- 4. CONTACT NUMBER: 78
- 5. CONTACT TYPE: F=FEMALE S=FEMALE (Phosphor Bronze)
- 6. CONTACT AREA PLATING:
  - G=Gold Flash
  - M=2µ" Gold Plated
  - S=Gold Flash (Selective)
  - A=5µ" Gold (Selective)
  - B=10µ" Gold (Selective)
  - C=15µ" Gold (Selective)
  - D=30µ" Gold (Selective)
  - H=1µ" Gold Flash and 30µ" on Contact Area
- 7. SHELL PLATING:
  - T=Tin Plated
  - N=Nickel Plated
  - Z=Zinc Plated
- 8. PROCESS OPTION: A=THRU. HOLE
- 9. PARTS OPTION: A=NON ACCESSORIES
- 10. CONTACT INSERTING OPTIN: A=Fully Loaded
- 11. INSULATOR COLOR:
  - 1=White
  - 2=Blue
  - 3=Black
  - 4=Grey
  - A=White+Logo
  - B=Blue+Logo
  - C=Black+Logo
  - D=Grey+Logo

UNLESS OTHERWISE SPECIFIED TOLERANCE	
ANG.	±5°
0.	±0.5
.0	±0.3
.00	±0.2

**MC-COMPONENTS**

SCALE: AS SHOWN UNIT: mm

DRAWN TERRY 08/26/05

CHECKED Joe 08/26/05

APPROVED Mike D 08/26/05

SIZE A4 REV. D

DRAWN NAME: HIGH DENSITY D-SUB SOLDER

PRODUCT NO. 101AX78XXXAAAX

FILE NAME: 101AK78FXXAAAX

REV.	DESCRIPTION	DATE	REV.	DESCRIPTION	DATE
C	ECN-0208089(Joe) △	08/19/02			
B	ECN-0101124	01/30/01			
A		05/02/97	D	ECN-0508082(Terry) △(7,E)(7,F)(7,G)(9,F)(7,C)	08/15/05

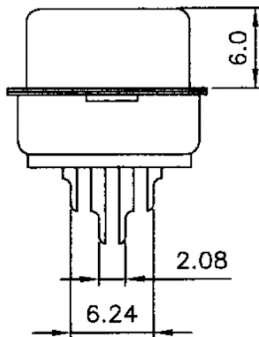
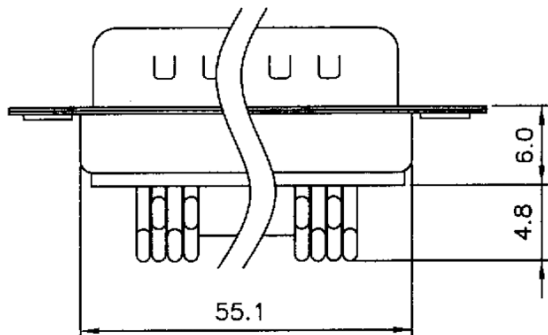
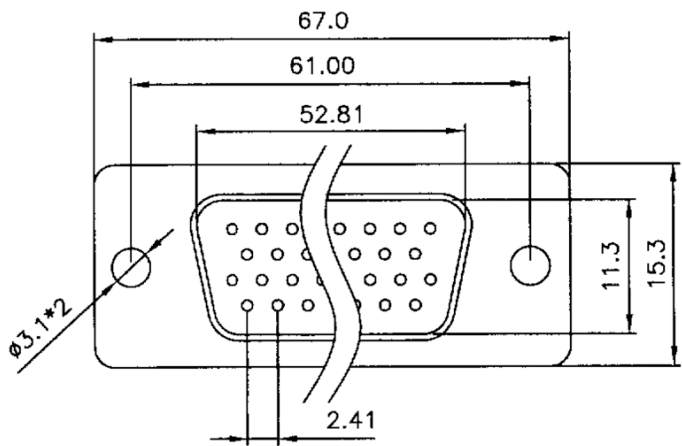

**SPECIFICATION**

- △ MATERIAL  
Insulator: Thermal Plastic UL94V-0  
Contacts: Copper Alloy  
Shell: Stainless Steel
- △ Rivet, Boardlock: Copper Alloy
- △ CONTACT PLATING  
Underplate: 50u" Nickel  
Contact Area: 1u"~30u" Selective Gold
- △ Solder Tails Area: 100u" Tin/Lead (Brighten Tin) or 100u" Tin/Lead Free (Brighten Tin/Matte Tin)

ELECTRICAL  
Operation Voltage: 250 VAC Max.  
Current Rating: 3 Amps Max.  
Contact Resistance: 15 mohms Max. △  
Dielectric Withstanding Voltage: 1000 VAC / Minute  
Operating Temperature: -55°C To +105°C  
PART NO.

101 A X 78 X X X A A A X  
1 2 3 4 5 6 7 8 9 10 11

- 1. SERIES NO.
- 2. TYPE: A=Standard
- 3. ENVIRONMENT PROTECTION MATERIAL:  
--General  
J=SONY SS-00259(Reserved)  
K=SONY SS-00259(Matte Tin) (Reserved)  
E=RoHS  
F=RoHS (Matte Tin)
- 4. CONTACT NUMBER  
7B
- 5. CONTACT TYPE:  
M=Male  
C=Male(一般塑膠)
- △ 6. CONTACT AREA PLATING:  
G=Gold Flash  
M=2u" Gold Plated  
S=Gold Flash (Selective)  
A=5u" Gold (Selective)  
B=10u" Gold (Selective)  
C=15u" Gold (Selective)  
D=30u" Gold (Selective)  
H=1u" Gold Flash and 30u" on Contact Area
- 7. SHELL PLATING:  
P=Tin Plated+Dimple  
Q=Nickel Plated+Dimple  
△ Z=Zinc Plated
- 8. PROCESS OPTION:  
A=THRU. HOLE
- 9. PARTS OPTION:  
A=Non Accessories
- 10. CONTACT INSERTING OPTIN:  
A=Fully Loaded
- 11. INSULATOR COLOR:  
1=White  
2=Blue  
3=Black  
4=Grey

UNLESS OTHERWISE SPECIFIED TOLERANCE	
ANG.	±5°
0.	±0.5
.0	±0.3
.00	±0.2
SCALE: AS SHOWN	UNIT: mm

**MC-COMPONENTS**

C	ECN-0208089(Joe)△	08/19/02				DRAWN	JOE	02/03/06	DRAWN NAME:	HIGH DENSITY D-SUB SOLDER
B	ECN-0101124	01/30/01	E	ECN-0602007(Lily)△(7,B)	01/26/06	CHECKED	Devi	02/06/06	PRODUCT NO.	101AX78XXXAAAX
A		05/02/97	D	ECN-0508082(Terry)△(7,G)(7,F)(7,E)(7,C)(9,F)	08/15/05	APPROVED	Mark	02/06/06	FILE NAME:	101AK78MXXAAAX
REV.	DESCRIPTION	DATE	REV.	DESCRIPTION	DATE	SIZE	A4	REV.	E	

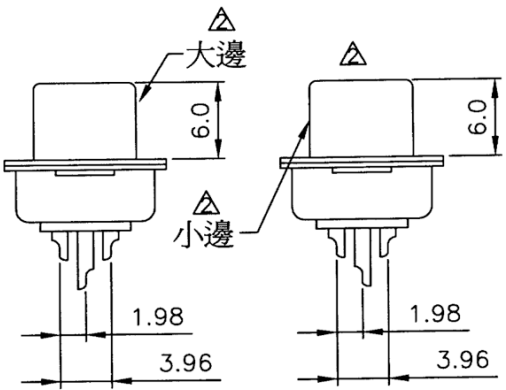
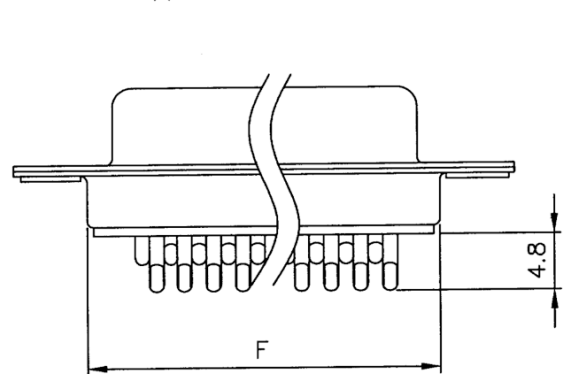
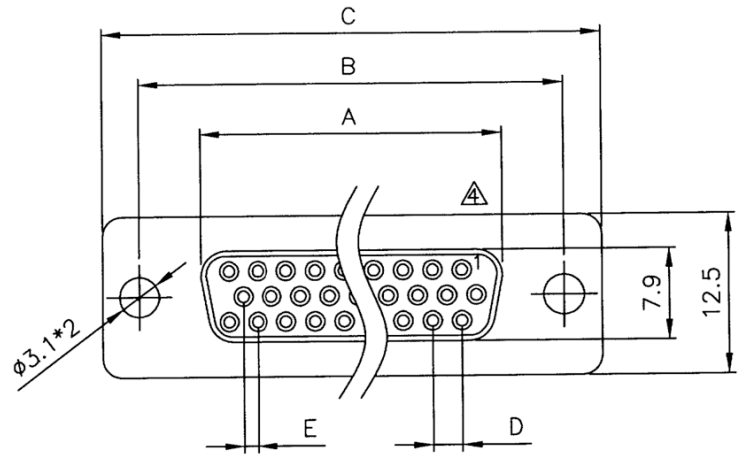

△杯口朝大邊(F,S)    △杯口朝小邊(G,H)

POSITION	A	B	C	D	E	F
15(F,S,G,H)	16.30	25.00	30.8	2.29	1.14	19.2
26(F,S,G,H)	24.60	33.30	39.2	2.29	1.14	27.7
44(F,S,G,H)	38.30	47.10	53.1	2.29	1.14	41.1
62(F,S,G,H)	54.80	63.50	69.4	2.41	1.20	57.3



**SPECIFICATION**  
**MATERIAL**  
 Insulator: Thermal Plastic UL94V-0  
 Contacts: Copper Alloy  
 Shell: Stainless Steel  
 Rivet,Boardlock: Copper Alloy  
**CONTACT PLATING**  
 Underplate: 50μ" Nickel  
 Contact Area: 1μ"~30μ" Selective Gold  
 Solder Tails Area: 100μ" Tin/Lead (Brighten Tin) or 100μ" Tin/Lead Free (Brighten Tin/Matten Tin)  
**ELECTRICAL**  
 Operation Voltage: 250 VAC Max.  
 Current Rating: 3 Amps Max.  
 Contact Resistance: 15 mohms Max.  
 Insulation Resistance 500 Mohm @ 500VDC.  
 Dielectric Withstanding Voltage: 1000 VAC / minute  
 Operating Temperature: -55°C to +105°C  
**PART NO.**

101 A X XX X X X A A A X  
 1 2 3 4 5 6 7 8 9 10 11

- 1.SERIES NO.
- 2.TYPE: A=Standard
- 3.ENVIRONMENT PROTECTION  
 MATERIAL  
 --General  
 J=SONY SS-00259(Reserved)  
 K=SONY SS-00259(Matte Tin)  
 (Reserved)  
 E=RoHS  
 F=RoHS (Matte Tin)
- 4.CONTACT NUMBER  
 15 26 44 62
- 5.CONTACT TYPE:  
 F=Female(杯口朝大邊)  
 S=Female (Phosphor Bronze)  
 (杯口朝大邊)  
 G=Female(杯口朝小邊)  
 H=Female (Phosphor Bronze)  
 (杯口朝小邊)
- 6.CONTACT AREA PLATING:  
 G=Gold Flash  
 M=2μ" Gold Plated  
 S=Gold Flash (Selective)  
 A=5μ" Gold (Selective)  
 B=10μ" Gold (Selective)  
 C=15μ" Gold (Selective)  
 D=30μ" Gold (Selective)  
 H=1μ" Gold Flash and 30μ" on Contact Area
- 7.SHELL PLATING:  
 T=Tin Plated  
 N=Nickel Plated  
 Z=Zinc Plated
- 8.PROCESS OPTION:  
 A=Thru. Hole
- 9.PARTS OPTION:  
 A=Non-Accessories
- 10.CONTACT INSERTING OPTIN:  
 A=Fully Loaded
- 11.INSULATOR COLOR:  
 1=White  
 2=Blue  
 3=Black  
 4=Grey  
 A=White+Logo  
 B=Blue+Logo  
 C=Black+Logo  
 D=Grey+Logo

UNLESS OTHERWISE SPECIFIED TOLERANCE	
ANG.	±5°
0.	±0.5
.0	±0.3
.00	±0.2

**MC-COMPONENTS**

SCALE: AS SHOWN	UNIT: mm
DRAWN JOE	05/24/07
CHECKED <i>pearl</i>	05/28/07
APPROVED <i>Blank et 28/07</i>	

DRAWN NAME:	HIGH DENSITY D-SUB SOLDER
PRODUCT NO.	101AXXXXXXAAAX
FILE NAME:	101AKXXFXXAAAX

REV.	DESCRIPTION	DATE	REV.	DESCRIPTION	DATE
C	ECN-0208089(Joe) △	08/19/02	F	ECN-0705180(Tiffany) △ (3,F)	05/24/07
B	ECN-0101124	01/30/01	E	ECN-0508082(Terry) △ (7,E)(9,F)(7,G)	08/15/05
A		05/02/97	D	ECN-0408054(Angela) △	08/13/04